

## Mounting CAD/CAM Block Locker™

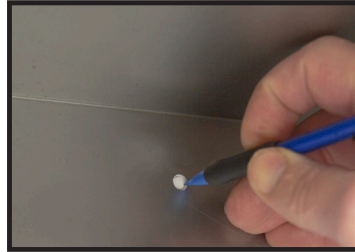

1) Remove shelves before mounting cabinet. Remove by lifting left lever and pushing down on right lever.



2) Place cabinet in desired location for mounting. Mark cabinet position on wall



3) Mark wall for hanger bracket. Proceed mounting the hanger bracket on wall using three 50 lb anchors.



4) Hang cabinet on the hanger bracket mounted on wall **CAUTION:** Without hanger bracket there is a risk of cabinet tipping or falling.

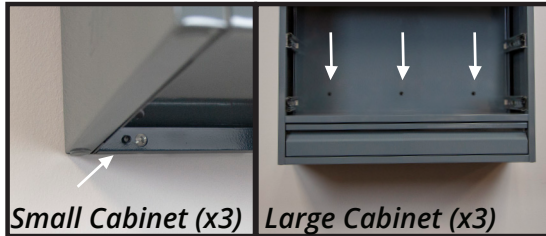

5) Fasten cabinet using the lower mounting holes. **CAUTION:** Without fastening to wall there is a risk of cabinet tipping or falling.



6) Replace shelves. Lift lever on left and push lever on right to insert.

### Counter Top Mount Option



### Hanging Wall Option



7) Organize and use cabinet

Zirc Dental Products, Inc. recommends a professional contractor to complete installation of your CAD/CAM Block Locker™ properly.



1) Option for individual/bulk block storage: Insert gray Block Divider.



2) Place individual milling blocks inside Block Divider by placing block side down.

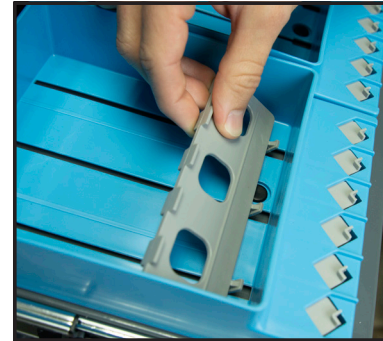

3) Option for block package storage: Place gray slide by inserting feet into open channels.



4) Place block packaging in front of slide



5) Pull gray slide tight against the back of block packaging, push base forward to lock in place.



6) Place individual blocks in \*front row of the Block Organizer.

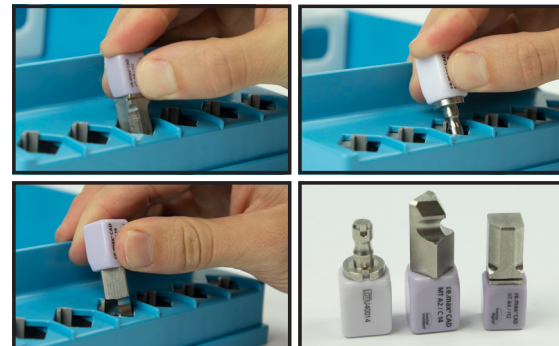

\* Spring loaded to accommodate most styles of milling block posts



7) Label Block Organizers utilizing our online custom template

Download Custom Label Template at [www.zirc.com/labels](http://www.zirc.com/labels)